

# D-SUB CONNECTORS

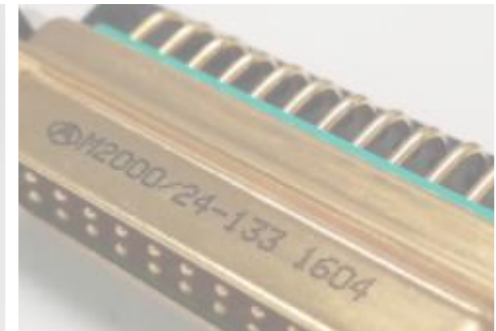

# TECHNICAL SPECIFICATIONS

## M2000-QPL-Crimp Version

|               | Characteristics         | Standard                  | High Density              |
|---------------|-------------------------|---------------------------|---------------------------|
| Material      | Shell                   | Steel / Brass             | Steel / Brass             |
|               | Insulator               | Thermoset/Thermoplast     | Thermoset/Thermoplast     |
|               | Contact                 | Copper Alloy              | Copper Alloy              |
| Finish        | Shell                   | Cadmium, Nickel, Gold     | Cadmium, Nickel, Gold     |
|               | Contact                 | Gold Over Nickel          | Gold Over Nickel          |
| Electrical    | Contact Rating          | 7.5A Max                  | 7.5A Max                  |
|               | Test Voltage-Max        | 1000 Vrms                 | 1000 Vrms                 |
|               | Insulation Resistance   | > 5000 m Ohm              | > 5000 m Ohm              |
|               | Contact Resistance      | 7.3m Ohm                  | 7.3m Ohm                  |
| Mechanical    | Insertion/Removal Force | 5N Max                    | 5N Max                    |
|               | Durability              | 500 Cycles                | 500 Cycles                |
|               | Wire Gauge              | AWG 20 - 28               | AWG 22 - 28               |
| Environmental | Temperature             | - 55 Deg C to + 125 Deg C | - 55 Deg C to + 125 Deg C |
|               | Salt Spray              | 48 Hrs                    | 48 Hrs                    |
|               | Damp Heat               | 10 Days                   | 10 Days                   |

## ORDERING INFORMATION

| A                  | M                           | 2000                               | /2             | XXX             |
|--------------------|-----------------------------|------------------------------------|----------------|-----------------|
| Manufacturers Logo | <b>Military Designation</b> | Specification Sheet Number (Class) | Connector Type | Connector Class |

### Connector Type

- 2: Receptacle Connector with Polarized Shell & Socket Crimp contact.
- 4: Plug Connector with Polarized Shell & Pin Crimp Contact.
- 6: Receptacle Connector with Polarized Shell with Socket Crimp Contact (Non-Magnetic)
- 8: Plug Connector with Polarized shell & Pin Crimp Contact (Non-Magnetic)

# ASSEMBLIES & ARRANGEMENTS

## Receptacle Assembly Exploded View

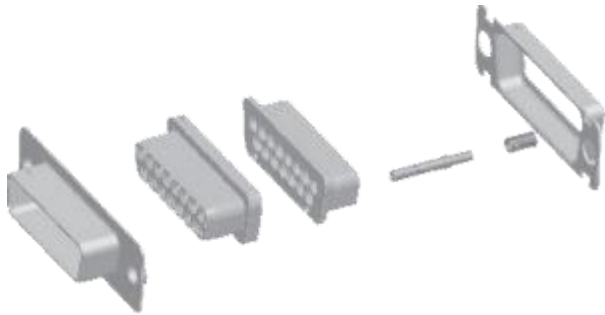

## Plug Assembly Exploded View

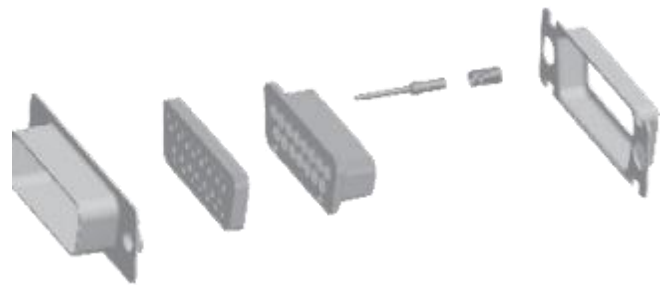

## Insert Arrangement for Standard D Sub Connectors

### Standard D Sub Connectors

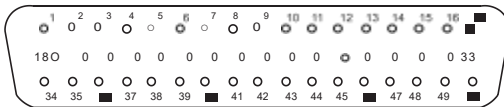
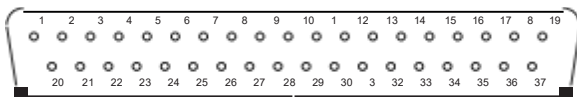
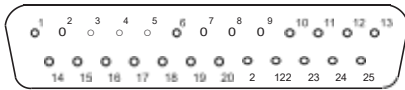
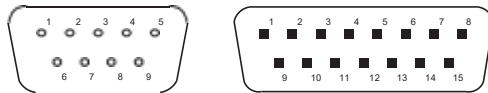

### High Density D Sub Connectors

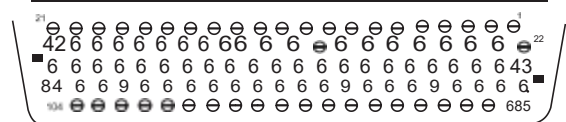
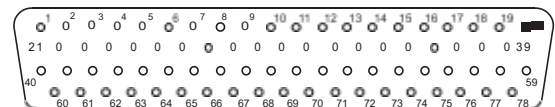
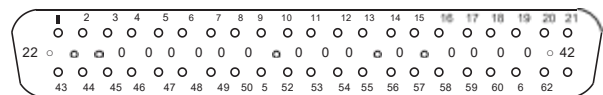
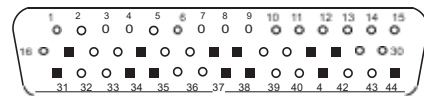
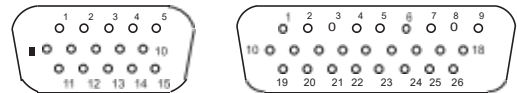

# POLARIZED SHELL & SOCKET CRIMP CONTACT

## Receptacle

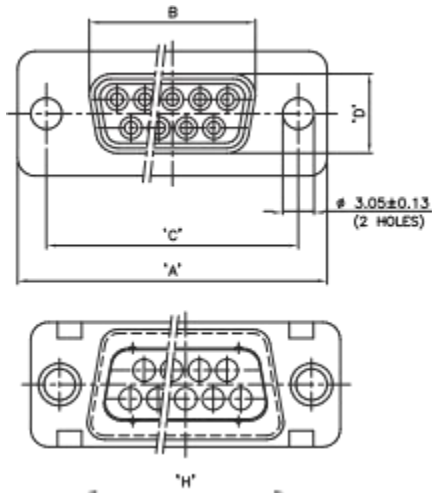

## Plug

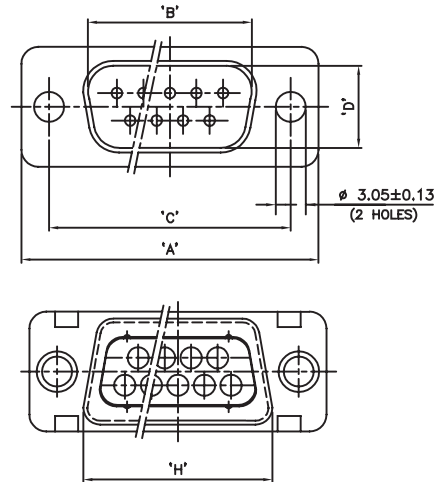

# POLARIZED SHELL & PIN CRIMP CONTACT-HIGH DENSITY

## Receptacle

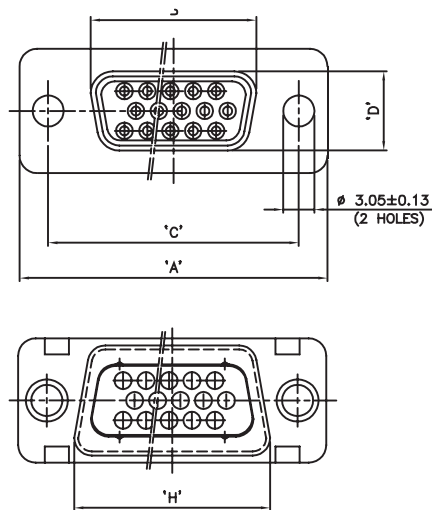

## Plug

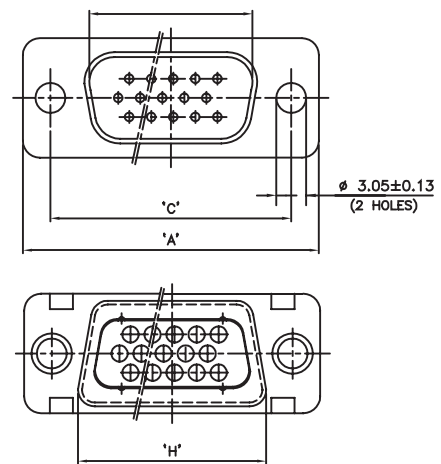

# CONTACT INFORMATION

## Standard D Sub

### Crimp Contacts-Closed crimp barrel

|            | Female   | Male  |
|------------|--|---|
| Material   | Copper Alloy   | Brass   |
| Plating    | Gold flash over nickel or 0.000050 inch (1,25 ) gold over copper for military specification contacts |   |
| Color Code | Orange / Blue / Grey for military specification contacts   | Orange / Blue / White for military specification contacts |

### Female Contact

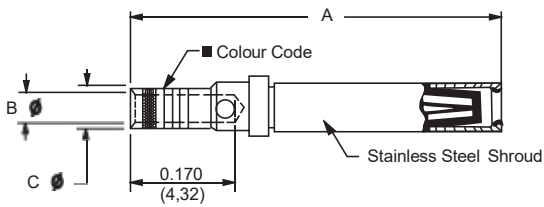

### Male Contact

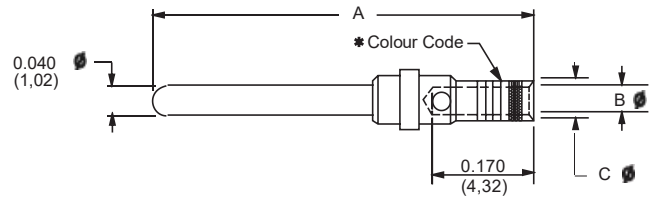

## High Density D-Sub

### Crimp Contacts-Closed crimp barrel

|            | Female   | Male  |
|------------|--|---|
| Material   | Copper Alloy   | Brass   |
| Plating    | Gold flash over nickel or 0.000050 inch (1,25 ) gold over copper for military specification contacts |   |
| Color Code | Orange/Green/Yellow for military specification contacts  | Orange / Blue / Black for military specification contacts |

### Female Contact

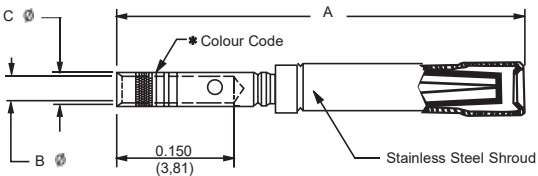

### Male Contact

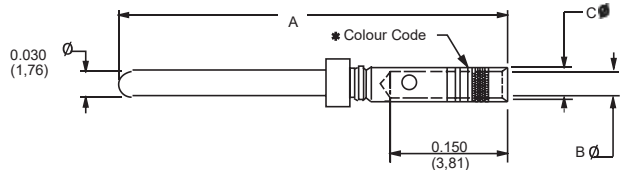

# SPECIAL PRODUCTS

## Solder Type Standard D-Sub Connector (Non Environmental)

**M2000 /3**  
Plug w/ Solder Contact

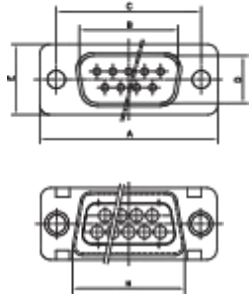

**M2000 /1**  
Receptacles w/ Solder Contact

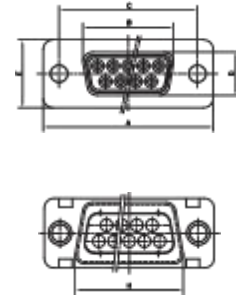

## Standard D Sub Grommet Type Connector (Crimp Type Contact)

**MM2000 /4**  
Plug w/ Pin Contact (w/ Grommet) - Rear Removable

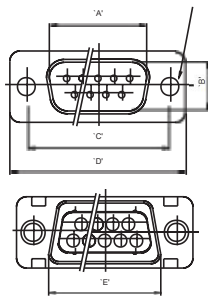

**M2000 /2**  
Receptacle w/ Socket Contact (w/ Grommet)-Rear Removable

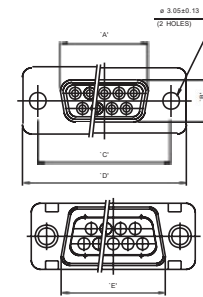

## D Sub Connector (Straight PC Tail Type)

**M2000 /24**  
Plug w/ Straight PC Tail Pin Contact

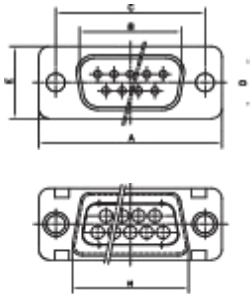

**M2000 /23**  
Receptacle w/ Straight PC Tail Socket Contact

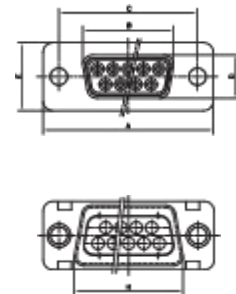

## Standard D Sub Connector (Right Angle PC Tail Contact)

**M2000 /24**  
Plug w/ Pin Contact, Right Angle PC Tail Contact

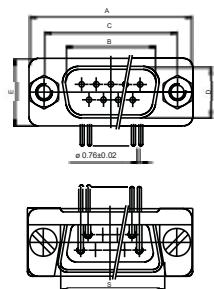

**M2000 /23**  
Receptacle w/ Socket Contact, Right Angle PC Tail Contact

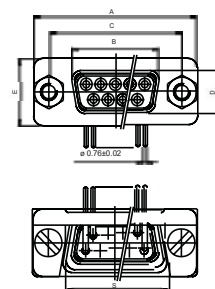

## Standard D Sub Connector (Right Angle PC Tail Contact w/ Extra PC Tail Length)

M2000 /24

Plug w/ Pin Contact, Right Angle PC Tail

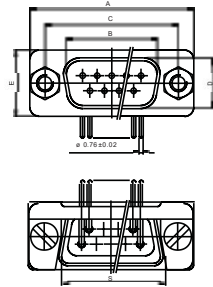

M2000 /23

Receptacle w/ Socket Contact, Right Angle PC Tail

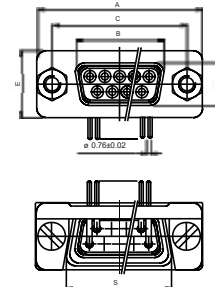

## High Density D Sub Connector (Right Angle PC Tail Contact)

M2000 /24

Plug w/ Pin Contact

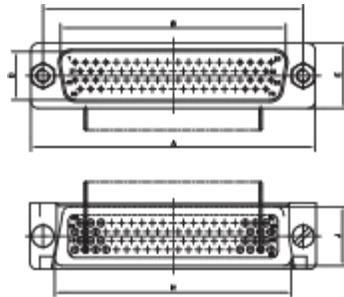

M2000 /23

Receptacles w/ Socket Contact

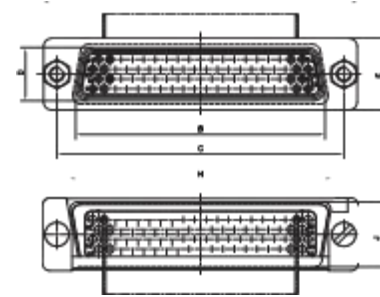

## Dust Cover

Plug

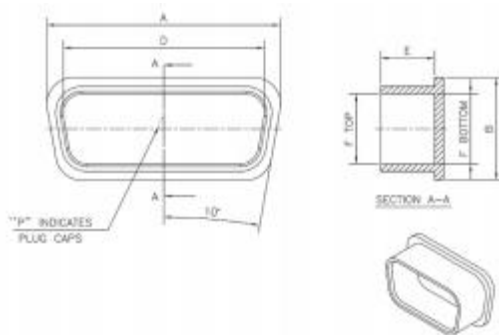

Plastic Dust Cap Receptacles

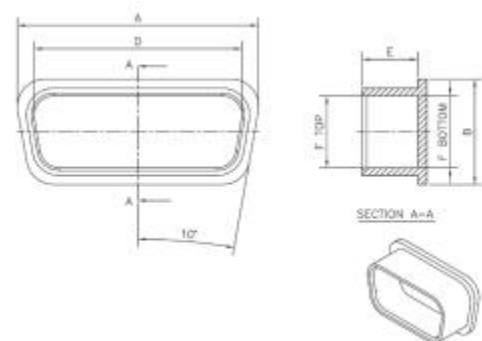

# PRODUCTS

---



BACKSHELLS



CABLE SOLUTIONS



CIRCULAR



GROUND BLOCKS



LUMINUS



MILITARY AUDIO/POWER



PEGASUS SERIES



RECTANGULAR



RUGGED SOLUTIONS



SIM



SOLARIS



SYSTEM ATTACHMENTS



[www.conntoconn.com](http://www.conntoconn.com)